

253/21-22

PROPOSED G+IV(14.5 M.=47'-6") STORED RESIDENTIAL BUILDING SITE PLAN OF SUBRATA MANNA, DEBABRATA MANNA, KAKALI BANERJEE & MITHU CHANDRA, AT- 5/2, M.M. FEERED ROAD, BELGHARIA KOL-56, C.S.& R.S.DAG NOS-3385(P), 3314, (P) 3384, 3386, 3384/4097, KHATIAN NOS-1109, 2315, 2316, MOUZA-ARIADHA KAMARHATI, WARD NO- 11, HOLDING NO- J.L. NO- 1, P.S.-BELGHARIA, UNDER KAMARHATI MUNICIPALITY.

AREA OF LAND- 35 K. 3 CH. 3 SFT. (2354.83 SQ.M.)

GR. COVERAGE -60 %

SCALE- 1:400

GR. FLOOR COV. AREA- 15223 SFT(1414.744 SQ.M.)

TOTAL COV. AREA- 76115 SFT.(7073.88 SQ.M.)

TYPICAL FLOOR COV. AREA- 15223 SFT. (1414.744SQ.M.)

SITE PLAN NO. 253/21-22

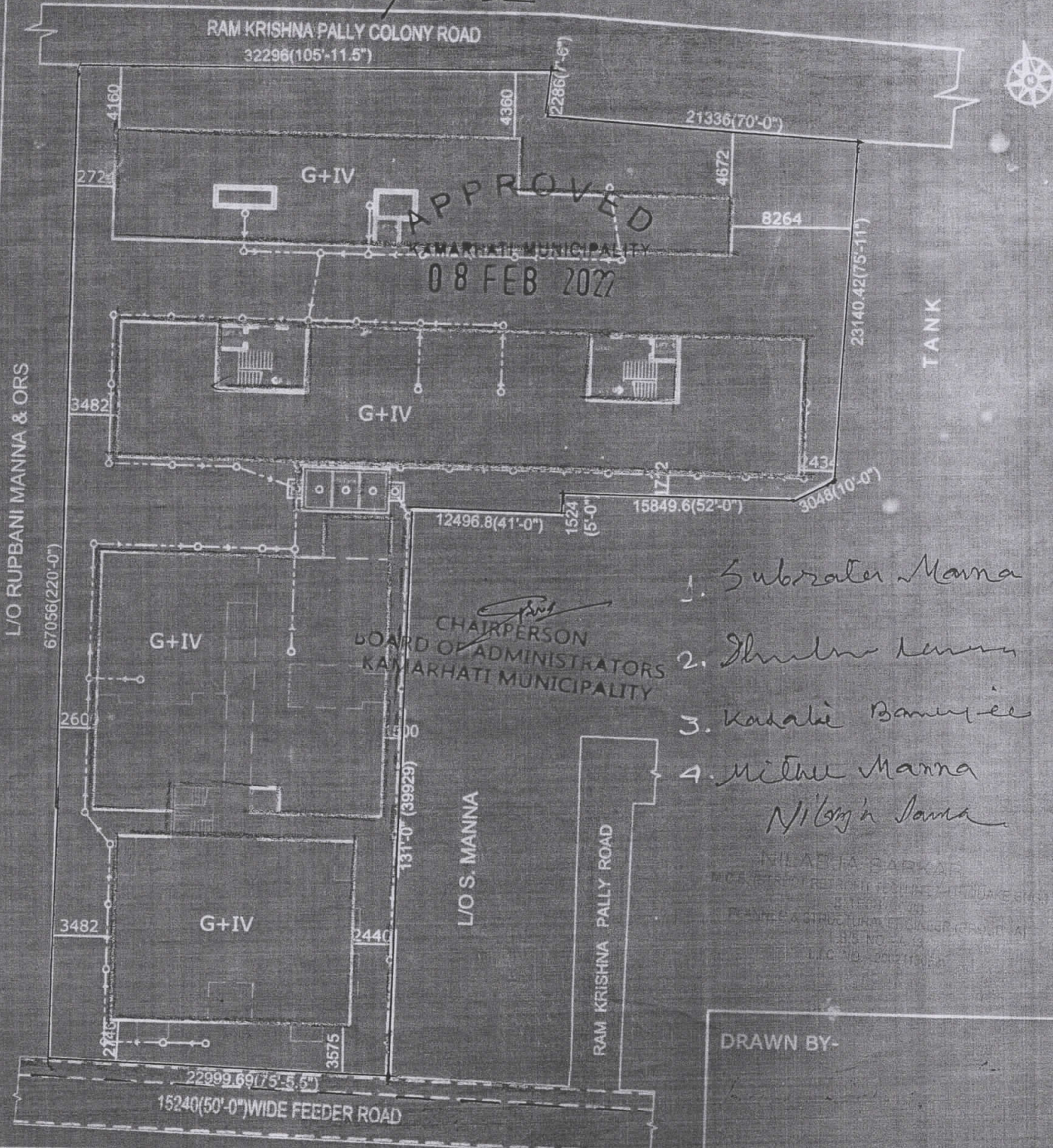

1. Subrata Manna
 2. Debabrata Manna
 3. Kakali Banerjee
 4. Mithu Manna
- Nilganga Sanna*

NILGANGA SANNAN
MURUGAN
REGISTERED ARCHITECT
NO. 100/2001
REGISTERED ARCHITECT
NO. 100/2001

DRAWN BY-

ADDITION & ALTERATION SITE PLAN OF G+V STORIED RESIDENTIAL BUILDING AT PREMISES NO.-5/3, M.M.FEEDER ROAD, ARIADHA, KOLKATA-57, MOUZA-ARIADHA-KAMARHATI, HOLDING NO.-363, WARD NO.-11, C.S. DAG NOS.-3385(P) & 3314(P), KHATIAN NO.-1109, J.L. NO.-1, P.S.-BELGHARIA, DIST.-24PARGANAS (NORTH) UNDER KAMARHATI MUNICIPALITY.

AREA OF LAND = 18 KH.-4 CH.-08 SQ.FT. = 1221.93 SQM. = 13148 SQ.FT.

EXISTING GROUND FLOOR AREA (59.0%) = 720.91 SQ.M. = 7757 SQ.FT.
 EXISTING FIRST FLOOR AREA = 767.66 SQ.M. = 8260 SQ.FT.
 EXISTING SECOND FLOOR AREA = 767.66 SQ.M. = 8260 SQ.FT.
 EXISTING THIRD FLOOR AREA = 767.66 SQ.M. = 8260 SQ.FT.
 EXISTING FOURTH FLOOR AREA = 767.66 SQ.M. = 8260 SQ.FT.
 PROPOSED FIFTH FLOOR AREA (49.49%) = 604.83 SQ.M. = 6508 SQ.FT.



SCALE

TOTAL FLOOR AREA = 4396.38 SQ.M. = 47305 SQ.FT.

1:200

HEIGHT OF THE BUILDING 17.350 M FROM GROUND LEVEL.

NAME OF THE ASSESSEE:- (1) RUPBANI MANNA, (2) SUBRATA MANNA, (3) DEBABRATA MANNA, (4) KAKALI BANERJEE, (5) MITHU CHANDRA.

C.S. DAG NO.-3313

SITE PLAN NO. 244/21-22

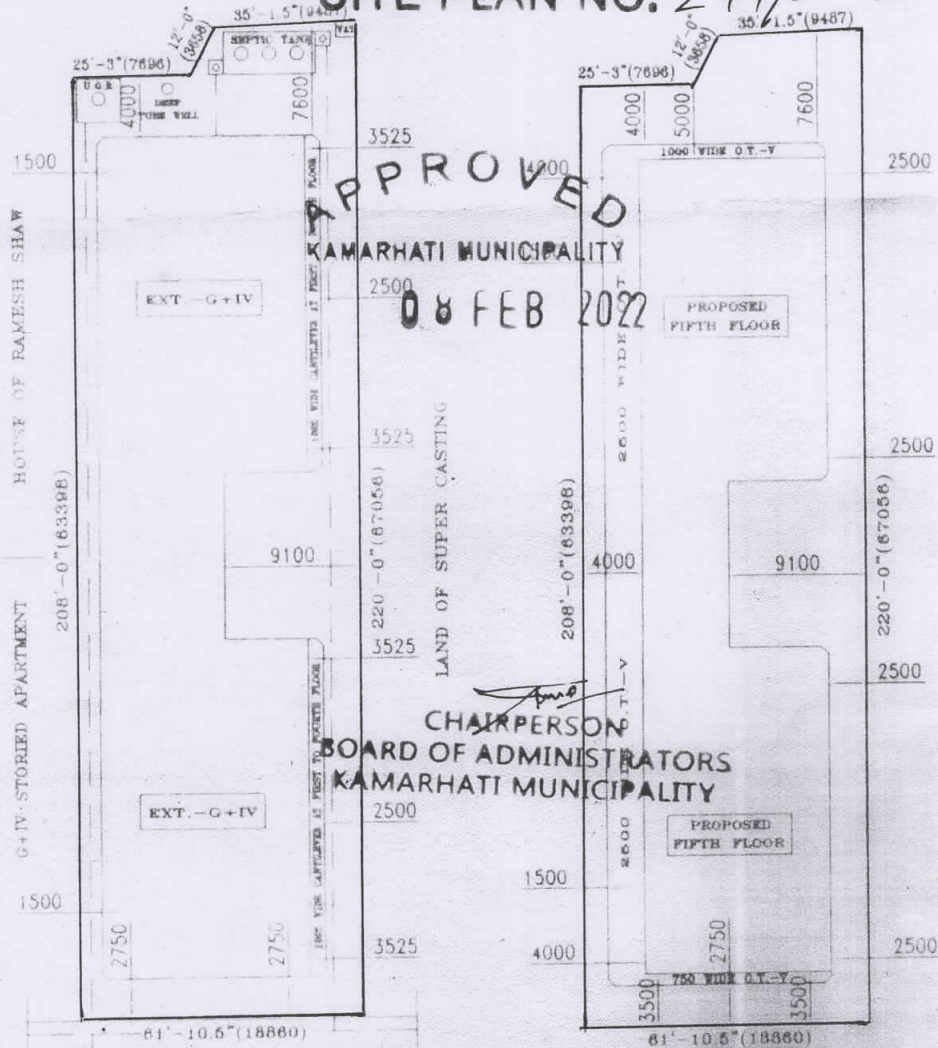

APPROVED
 KAMARHATI MUNICIPALITY
 08 FEB 2022

CHAIRPERSON
 BOARD OF ADMINISTRATORS
 KAMARHATI MUNICIPALITY

PROP. SITE PLAN

EXT. SITE PLAN

SIGNATURE OF THE L.B.S.:

SIGNATURE OF THE OWNER/S:

1. *রাপানী মন্না*
2. *Subrata Manna*
3. *Subrata Manna*

Search: jdm galaxy



JDM Galaxy
4.0 ★★★★★ (8)
Condominium complex

Overview | Reviews | About

Directions | Save | Nearby | Send to phone | Share

5/2, Feeder Rd, SP Paul Pally, Belghoria, Kolkata, West Bengal 700057

Closed · Opens 10 am Thu

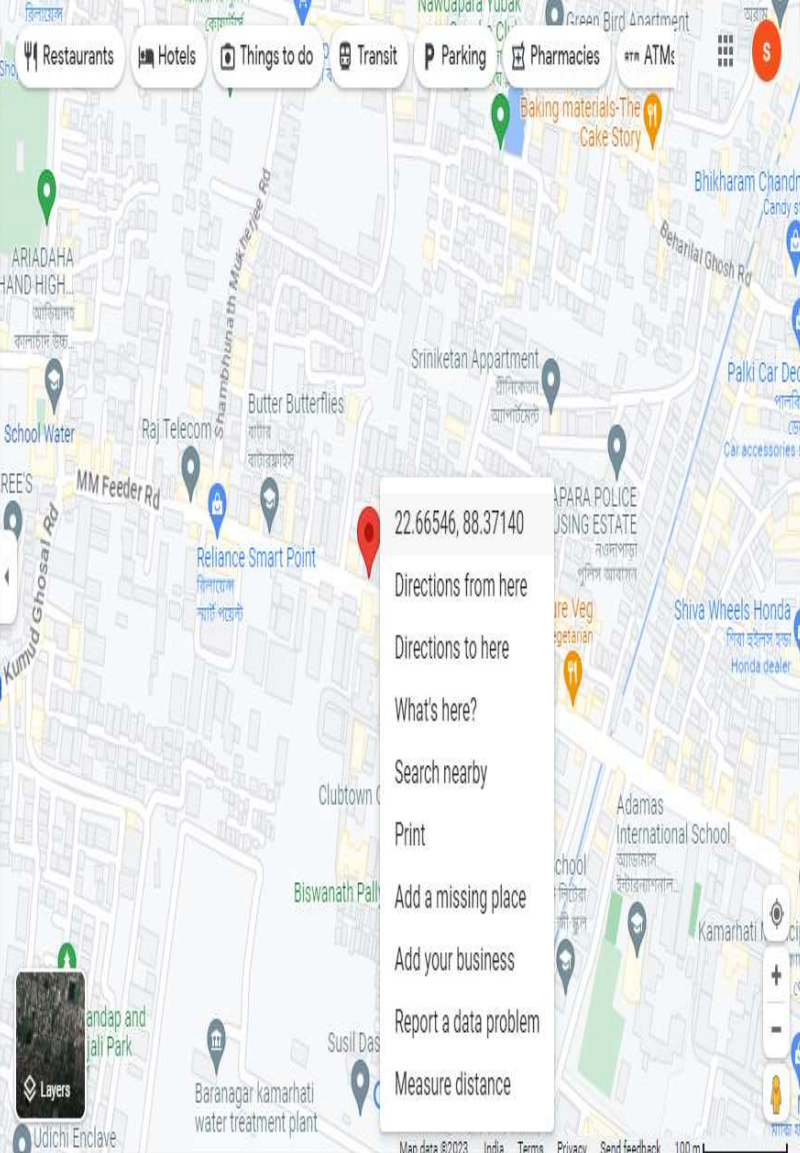

Context Menu:

- 22.66546, 88.37140
- Directions from here
- Directions to here
- What's here?
- Search nearby
- Print
- Add a missing place
- Add your business
- Report a data problem
- Measure distance

